

PRECISION MEDICAL® Flowmeter Replacement Parts

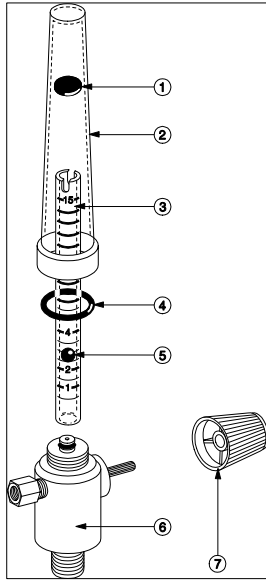

Description		Model # 1MFA2001 0-15 l/min AIR 50psi (3.4 bar)	Model # 1MFA9001 0-70 l/min AIR 50psi (3.4 bar)	Model # 1MFA5001 0-8 l/min AIR 21psi (1.4 bar)	Model # 1MFA1211 0-15 l/min AIR 21psi (1.4 bar)
1	Disc	1114	1009	1114	
2	Housing	1143		1143	
3	Flow Tube	1011	1031	502459	502117
4	Tetraseal™	1123		1123	
5	Float Ball	508164	1029	508164	1154
6	Body Assembly	504434	504824	504407	
7	Knob	1008		1007	

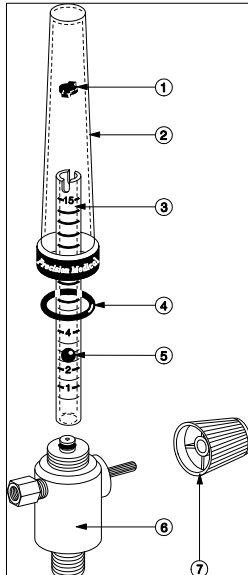

Description		Model # 1MFA3501 0-5 l/min OXYGEN 50psi (3.4 bar)	Model # 1MFA4001 0-8 l/min OXYGEN 50psi (3.4 bar)	Model # 1MFA1001 0-15 l/min OXYGEN 50psi (3.4 bar)	Model # 1MFA8001 0-70 l/min OXYGEN 50psi (3.4 bar)
1	Disc	1009		1114	1009
2	Housing	1143			
3	Flow Tube	1012	1152	1010	1021
4	Tetraseal™	1123			
5	Float Ball	1005	508164		1029
6	Body Assembly	505271	504407		504823
7	Knob	1007			

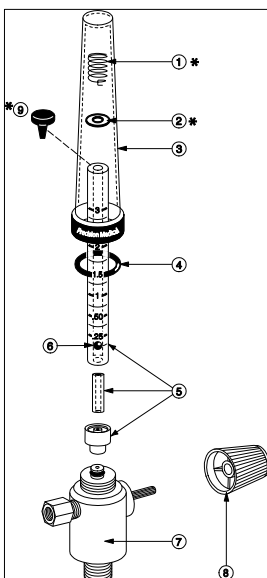

Description		Model # 6MFA1001 0-200 cc OXYGEN 50psi	Model # 4MFA1001 0-1 l/min OXYGEN 50psi	Model # 1MFA3001 0-3 l/min OXYGEN 50psi
1*	Spring	NA		1575
2*	Washer	NA		1787
3	Housing	1143		
4	Tetraseal™	1123		
5	Flow Tube Kit	503213	503214	503215
6	Float Ball	1576		1005
7	Body Assembly	1891	1897	502053
8	Knob	1007		
9*	Holder	506176		NA